

# QU236

self sufficient energy concept  
water + solar

24h offices  
transformation for night and  
weekend use

working with forest view

walking and cycling path

unlimited animal kingdom  
humans as considerate guests

Office Concept

## My forest is my office - a manifesto for another working culture

In a world where office monotony pervades, lurking at every corner, our lives yearn for a taste of adventure. We bind you just that - an exhilarating escape from the mundane! Introducing the Camping Office, where the spirit of adventure permeates the very essence of work. Inspired by elements of camping, we have crafted an office experience that transcends the ordinary, embracing the thrill of the outdoors while boosting productivity and igniting creativity. Step into a realm where work becomes an exhilarating journey, where the confines of traditional office walls melt away, and the spirit of exploration thrives. Welcome to the Camping Office, where the adventure of work begins!

The traditional concept of work has undergone a remarkable transformation, the need for conventional office quarters has dissipated. With the rise of remote and home-based work, as well as a growing skepticism towards hierarchical structures, the notion of dull, glass-covered office spaces has become obsolete. As an investor, it's clear that these once sought-after buildings

are now impractical, destined to remain vacant. The future of office architecture calls for a complete paradigm shift, demanding spaces that possess a unique allure to attract individuals back into the physical workspace. Moreover it is crucial to consider the pressing issues of climate and biodiversity crises. With these challenges in mind, it becomes evident that clearing forests and paving vast areas with concrete for conventional office buildings is no longer viable. We must find a way to preserve the forest as habitat for animals and mushrooms while also creating innovative workspaces that offer a truly unique experience. In this context, the need to strike a balance between environmental sustainability and the creation of exceptional work environments becomes paramount. It is no longer acceptable to sacrifice the natural world in the pursuit of productivity. Instead, we must explore alternative approaches that celebrate the integration of nature and work, preserving our forests while designing remarkable spaces that inspire and motivate.

In our vision of a new business city, office buildings have taken on an entirely new character, offering something extraordinary

to entice individuals to work within their walls. Picture an office nestled amidst a serene forest, where humans are once again in harmony with nature. As we gaze out the window, we witness a graceful deer leisurely strolling through the Swedish woods. The melodies of birdsong fill the air, creating a peaceful ambiance. Secluded from the hustle and bustle, we find solace and the ability to concentrate, inspired by the dense forest that surrounds us. These new office buildings blend seamlessly with their natural surroundings, incorporating sustainable materials and eco-friendly practices. Instead of monotonous cubicles, the curved office buildings doge the trees and harmonizes with the organic shapes and textures of the forest. The five-store buildings are raised off ground on stilts and allow nature and animals to flow beneath them. Collaborative areas are nestled amidst clearings, providing spaces for innovative thinking and dynamic teamwork. Tranquil pathways wind through the forest, connecting different working zones, stimulating creativity and fostering a sense of exploration.

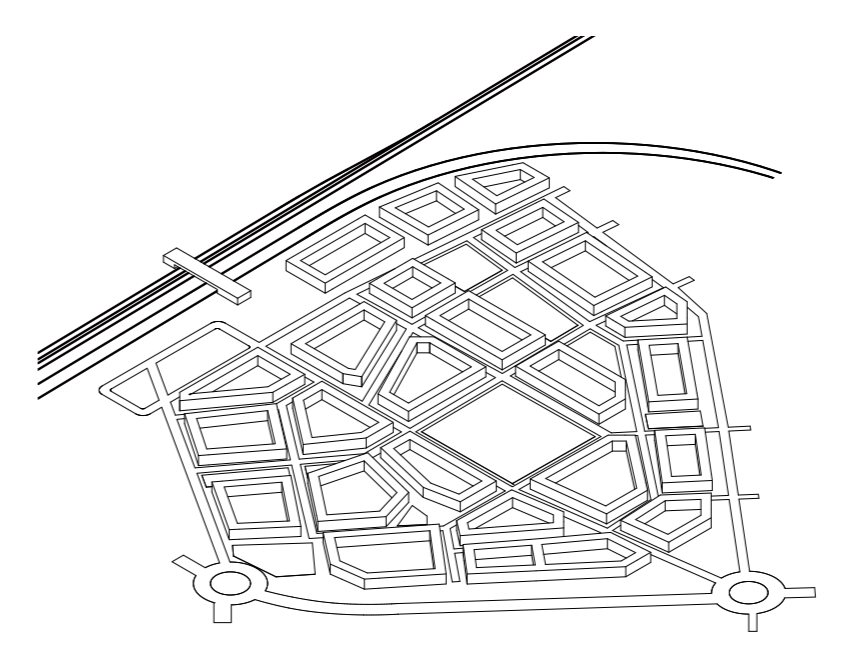

footprint of buildings on the ground 66.284 m2  
total area for rent 265.135 m2  
green space 30.228 m2  
sealed surface 121.337 m2 (streets + buildings)  
office area per person 9 m2  
total number of workspaces 29.459  
use of space: 5days x 8h = 40h/week  
rent: 250 SEK/m2  
income for investor: 250 SEK/m2 x 265.135 m2 = 66.283.750 SEK

**Masterplan by Skavska Municipality**  
Boring urban development, cutting down the forest, work district without atmosphere, commuters only come to earn money, high costs. Boring urban development, work district without atmosphere, run-of-the-mill office areas where commuters only come to earn money, cutting down the forest, high costs

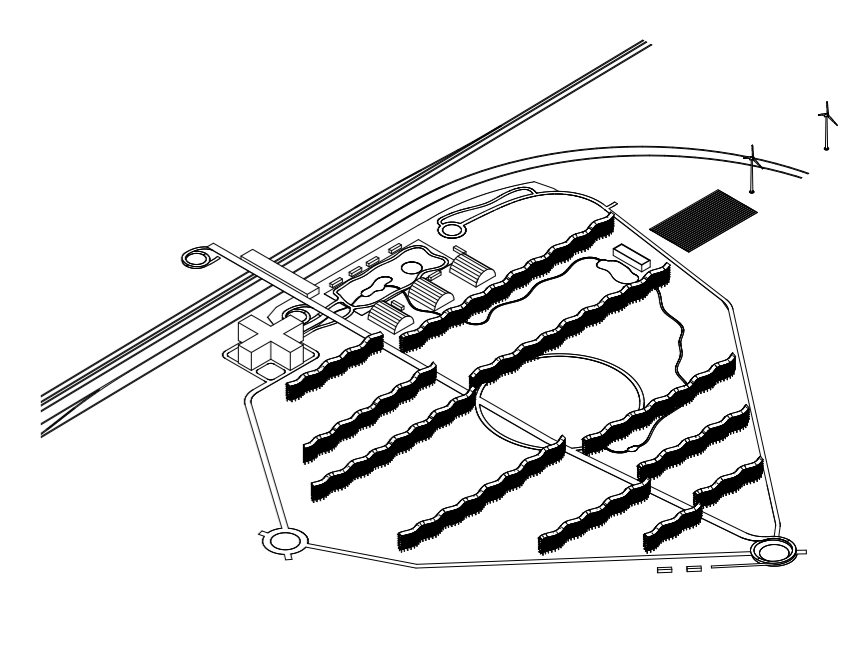

footprint of buildings on stilts 13.285 m2  
footprint of buildings the ground 4.633 m2  
total area for rent 101.143 m2  
green space 282.401 m2  
sealed surface 7.971 m2  
office area per person 3,5 m2  
total number of workspaces 28.898  
use of space: 7 days x 24h = 168h/week  
efficiency: 4 times better  
rent: 200 SEK/m2 x 4 (4 different tenants) = 800 SEK/m2  
income for investor: 800 SEK/m2 x 101.145m2 = 80.916.000  
profitability: 1,22 times better  
better 100x better for humans, animals and nature

**Our proposed Masterplan**  
more forest, less sealing, space for animals, climate and energy neutral, unique working conditions, just as much rent for the investor, more adventure, visitors from all around the world, a manifesto for another working culture, the Swedish version of a Silicon Valley.